

# Instructions

## To Simulate an Erection

To transfer the fluid to the cylinders, locate the pump in the scrotum. Squeeze the pump firmly a few times between the thumb and fingers until an erection is achieved.

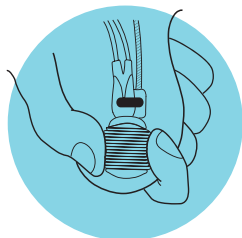

Squeeze pump to inflate.

## To Return to a Flaccid State

To return the fluid balance to the reservoir, follow the tip of the Pump as it narrows until the protruding bars are felt. Position thumb and finger on the release bars above the pump.

Place thumb on one bar and a finger on the opposite bar. Squeeze release bars with firm and steady pressure. Continuous pressure is necessary.

## To achieve a Flaccid State more quickly

Squeeze the penis gently with the other hand while squeezing the release bars.

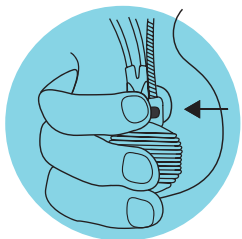

Use continuous pressure on release bars.

If any problems are encountered during the use of this device, or any pain or discomfort are experienced, please contact your doctor immediately.



MRI  
Conditional

- Static magnetic field of 3 Tesla or less
- Spatial gradient field of 720 Gauss/cm or less.
- Maximum whole-body-averaged specification absorption rate (SAR) of 3W/kg for 15 minutes of scanning produced a temperature rise of less than 0.5°C.

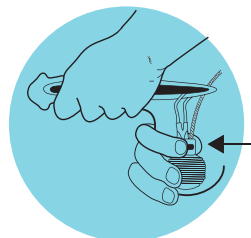

Grasp and squeeze.

# Patient Identification Card



MRI  
Conditional

## I Have a Coloplast Prosthetic Implant.

To Whom it May Concern: In case of emergency, please be aware that I have a 3-piece Coloplast Inflatable Penile Implant that contains metal. The implant is MRI conditional. See opposite side and Instructions for Use for details. Customer Service: 1-800-258-3476

Name: \_\_\_\_\_

Address: \_\_\_\_\_

City/State: \_\_\_\_\_

Surgeon: Dr. \_\_\_\_\_ Telephone: \_\_\_\_\_

Hospital: \_\_\_\_\_ City: \_\_\_\_\_

Date Implanted: \_\_\_\_\_

Health Insurance Provider: \_\_\_\_\_

Policy #: \_\_\_\_\_

In Case of Emergency, Please Notify:

Name: \_\_\_\_\_

Address: \_\_\_\_\_

City/State: \_\_\_\_\_

Telephone: \_\_\_\_\_ Relationship: \_\_\_\_\_

## Titan<sup>®</sup> Inflatable Penile Prosthesis

